

**CITY OF TUKWILA
Public Works Department
206-433-0179**

BULLETIN A8

ALLENTOWN FLOOD CONTROL ZONE FLOOD-PRONE AREA DESIGNATION

March 3, 2000

Subject: Policy 2000-01 Revision #1
Allentown Flood Control Zone
Flood-prone Area Designation

References:

- a) Code of Federal Regulations Title 44, Chapters 59 and 60
- b) Washington Administrative Code 173-158
- c) Revised Code of Washington Chapter 86
- d) Flood Insurance Study, Revised November 8, 1999
- e) Allentown Drainage Plan, HDR Engineering, 1993

The above regulations assign the City with the responsibility of using the best available information to describe flood-prone areas not described in the Flood Insurance Study.

Historically, portions of Allentown flooded during storm events coupled with high river events within the boundaries shown on the attached map. In 1997, the city installed a stormwater pump at S. 122nd Street and 42nd Avenue S., which is operated during late fall, winter, and early spring. The pump alleviated the seasonal flooding in this area but without the pump operating correctly, the area is still subject to historical flooding. In order to protect present and future homeowners within the boundary and to allow them to qualify for flood insurance, the Public Works Director designated the area shown within the boundaries as flood-prone.

The Senior Stormwater Engineer determined the flood elevation using the Flood Insurance Study and the elevation of the Allentown outfall into the Duwamish/Green River. On the Flood Insurance Study map, the Allentown outfall is located between sections J and K. The flood elevation at the outfall upstream from section J was calculated as 10.4'. This is the base flood elevation for Allentown within the boundaries shown on the attached map.

In general, the boundary description is :

- a) Bounded on the north by S. 116th St.
- b) Bounded on the south by S. 122nd St. and S. 60th St. (part)
- c) Bounded on the east by Burlington Northern-Santa Fe
- d) Bounded on the west by 42nd Ave. S. (part), 49th Ave. S (part), 51st Pl. S. (part) and 60th Pl. S. (part) The westerly boundary includes all the lots abutting 44th Ave. S.

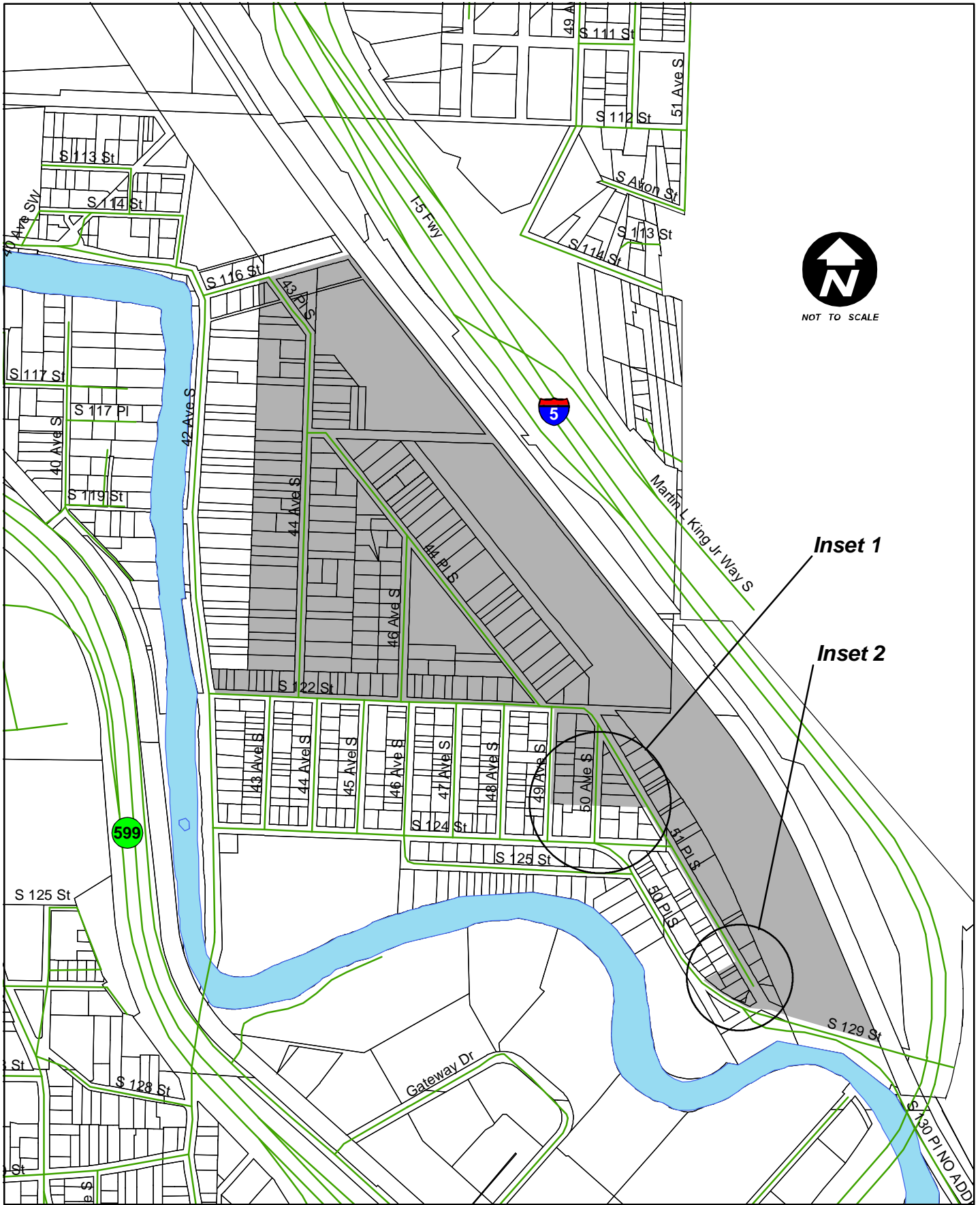

Allentown Flood Control Zone

Policy 2000-01
Figure 5

Disclaimer:
The location of features and
boundaries are approximate and
are intended for reference only.



Date: November 23, 2004



Allentown Flood Control Zone

Disclaimer:
The location of features and
boundaries are approximate and
are intended for reference only.

Policy 2000-01
NTS
Inset 1



Date: November 23, 2004

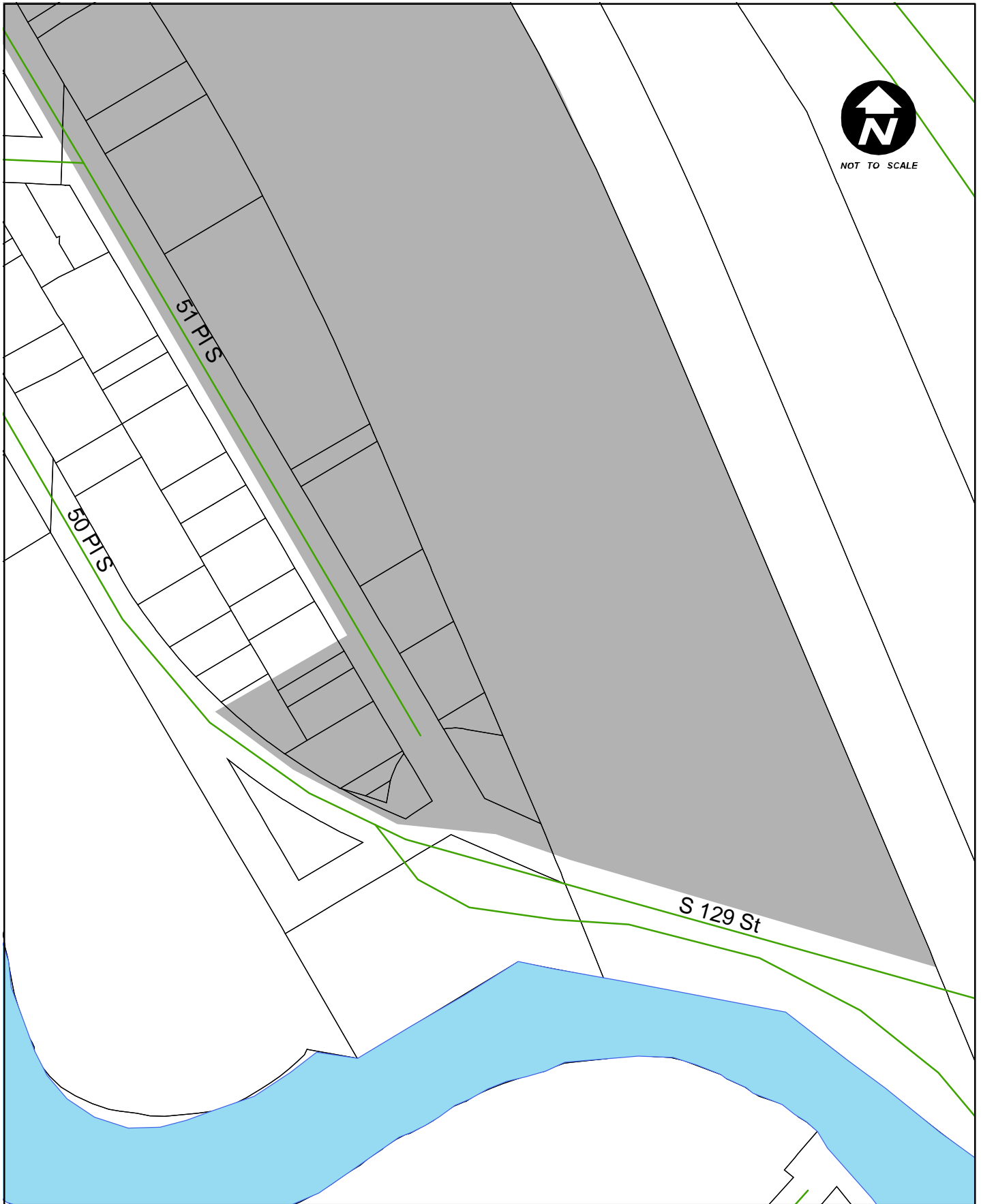

Allentown Flood Control Zone

Disclaimer:
The location of features and
boundaries are approximate and
are intended for reference only.

Policy 2000-01
NTS
Inset 2



Date: November 23, 2004